

Overview

HP Engage One Prime and HP Engage One Prime Plus

FRONT VIEW (Retail Associate side)



Overview

SKU Configurations

REAR VIEWS OF DIFFERENT SKUs (Customer side)

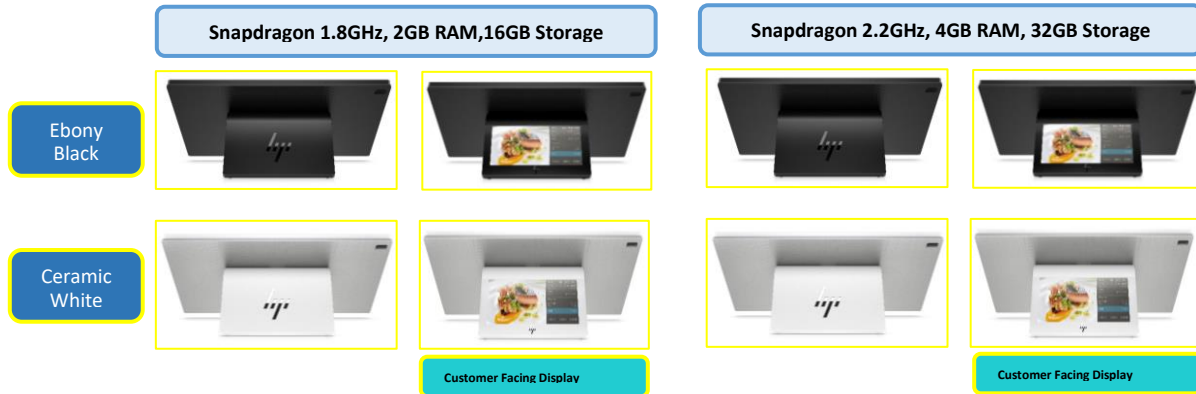

Overview

FRONT SIDE Overview

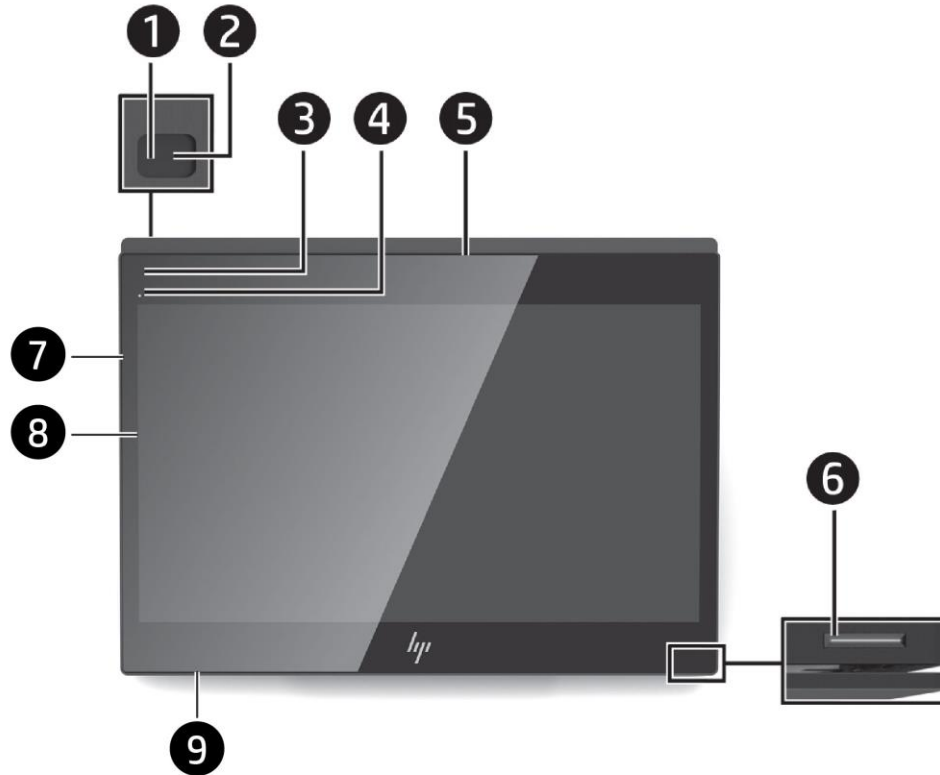

FRONT SIDE (Components)

- | | | | |
|----|--|----|--|
| 1. | Rear-facing camera (can also work as a barcode scanner*) | 6. | Power light |
| 2. | Rear-facing camera light | 7. | Microphone |
| 3. | Magnetic stripe reader light | 8. | 14-inch diagonal display panel (wide-aspect ratio); FHD 1920 x 1080 resolution Projected Capacitive Touch Screen |
| 4. | Front-facing camera | 9. | Speaker |
| 5. | Magnetic stripe reader | | |
- [*Requires software support](#)

Overview

REAR SIDE Overview

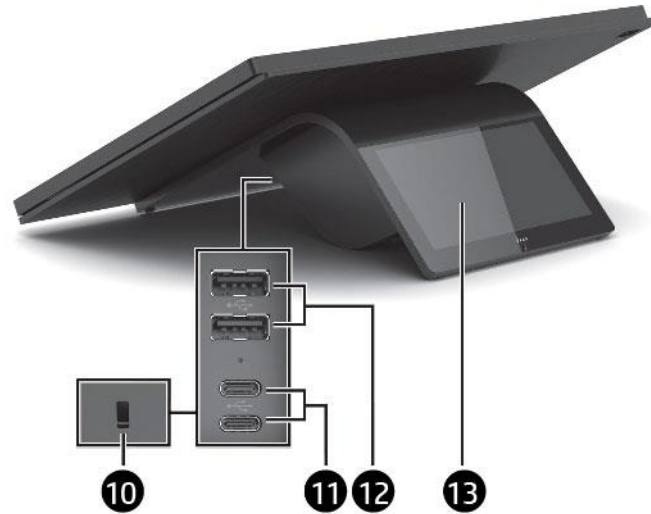

REAR VIEW Components)

- | | | | |
|-----|---------------------|-----|--|
| 10. | Security Cable Slot | 12. | USB 2.0 ports (2) |
| 11. | USB-C™ ports (2) | 13. | Customer-facing Display (CFD) - optional |

Overview

BOTTOM SIDE Overview

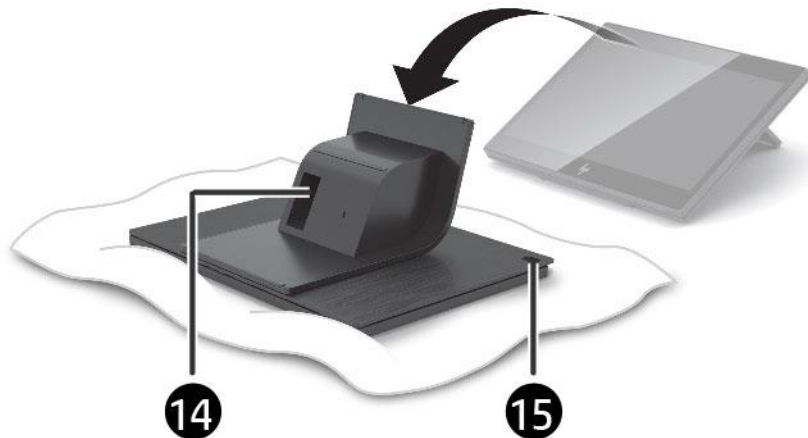

BOTTOM VIEW Components)

- 14 Ports / cables receptacle .
- 15 Rear View camera (can use used as a barcode scanner)* .

*Requires software support

Overview

Component Breakdown

NFC reader



NFC is in the center of the display for badge scanning

Magnetic Stripe Reader



MSR is behind the top section of the display (badge authentication only*)

*Authentication software required and sold separately.

Overview

Camera based barcode scanner



Camera based barcode scanner* is behind the top corner of the display

[*Appropriate software drivers required](#)

Overview

At A Glance

- 2 choices of performance CPU , memory, storage)
 - Engage One Prime: Qualcomm® Snapdragon APQ8053, 64 bit ARM Cortex A53 octa core processor (1.8 Ghz);, 2GB memory, 16GB storage*
 - Engage One Prime Plus: Qualcomm® Snapdragon APQ8053, 64-bit ARM Cortex-A53 Octa-core, 4GB memory, 32GB storage*
- 2 choices of colors
 - Ebony Black
 - Ceramic White
- Display: 14" diagonal Wide Aspect ratio; Full HD 1920 x 1080 Resolution, Anti-glare
- Customer Facing Display (optional): 5.5" diagonal Wide Aspect Ratio; Full HD 1920 x 1080 Resolution
- Operating System: Android™ 8.1 "Oreo"
- Peripheral options (can be purchased and installed separately):
 - HP Engage One Prime I/O Dock
 - HP Engage One Prime Printer
 - HP Engage One Prime Barcode Scanner
 - HP Engage One Prime Fingerprint Reader
 - HP Engage One Prime iButton Reader
 - HP Engage One Prime Cash Drawer
- ENERGY STAR® certified, EU Compliant, RoHS2 Compliant, EPEAT® Sliver
- Main unit: 45W USB Type C™ PD power adaptor, 87.8% efficient at 15V, active PFC
- I/O Dock: 120W Barrel type power adaptor, 88% efficient, active PFC
- Standard Warranty Options –1/1/1,1/1/0; Plus Optional Care Packs
- Software: Android™ 8.1

*For storage drives, GB = 1 billion bytes. Actual formatted capacity is less. Up to 7GB of disk is not user available.

NOTE: See important legal disclosures for all listed specs in their respective features sections.

Standard and Configurable Components

PROCESSORS

Qualcomm® Snapdragon APQ8053, 64-bit ARM Cortex-A53 Octa-core, 1.8Ghz¹
Qualcomm® Snapdragon APQ8053, 64-bit ARM Cortex-A53 Octa-core, 2.2Ghz¹

NOTE 1: Multicore is designed to improve performance of certain software products. Not all customers or software applications will necessarily benefit from use of this technology. Performance and clock frequency will vary depending on application workload and your hardware and software configurations. Qualcomm's numbering is not a measurement of clock speed.

Memory/Storage

2G(LPDDR3)/16GB (eMMC)
4G(LPDDR3)/32GB (eMMC)

Customer Facing Display

Integrated 5.5" diagonal CFD(1920x1080 AMOLED panel (optional)

Colors

Ebony Black
Ceramic White

Standard and Configurable Components

MAIN DISPLAY^{*,**}

14" diagonal Full HD, Ultra Wide Viewing Angle Main Display

Touch Technology:	Projected Capacitive Touchscreen
Resolution	1920(H) x 1080(V)
Aspect Ratio	16:9
Max Color	262K
Brightness	Typical 220 nits (LCM)*
Contrast Ratio	Typical 700:1*
Pixel Pitch	161 um x 161 um
Viewing Angle	Horizontal 850, Vertical 850
Response rate	30ms
Backlight	LED
Surface treatment	Anti-Glare
Operating Temperature range	0 to 50°C

* Nits is the measure of the typical brightness of the panel as specified, prior to anti-glare coating

** All specifications represent the typical specifications provided by HP's component manufacturers; actual performance may vary either higher or lower.

CUSTOMER FACING DISPLAY (Optional)

5.5" diagonal Full HD, Wide Viewing Angle Customer Facing Display

Display Technology:	AMOLED
Resolution	1920(H) x 1080(V)
Aspect Ratio	16:9
Max Color	16.7M
Brightness	Typical 420 nits
Contrast Ratio	Minimum 100K:1
Pixel Pitch	63.25 um x 63.25 um
Viewing Angle	All view
Response rate	1ms
Operating Temperature range	0 to 50°C

WIRELESS FUNCTION

Wireless LAN Standards¹	IEEE 802.11a IEEE 802.11b IEEE 802.11g IEEE 802.11n
---	--

Frequency Band	2.4Ghz/5Ghz
-----------------------	-------------

Bluetooth® Specification	V4.2
Frequency Band	2.4Ghz

Standard and Configurable Components

NFC (Integrated)

Integrated NFC solution supporting P2P and R/W working modes for Type A, B, and F signals with NFC forum standard tags of type 1, type 2, type 3, and type 4.

NOTE 1: Wireless access point and internet service required and sold separately. Availability of public wireless access points limited.

Magnetic Stripe Reader

MSR Reader¹

Integrated MSR reader, triple-track head, ISO 7811/7812/7813 Compliant, encryption capable

NOTE 1: Internet access and MSR authorization software required and sold separately.

NOTE 2: MSR configuration utility is not available for module.

Front Camera

Front camera

Integrated front camera (5M, FF)

Barcode Reader

Back camera

Integrated back camera (5M, FF) with flash LED

Acoustic functions

1 microphone

Integrated

1 speaker

Integrated, 1W, Embedded codec.

I/O Ports

USB-C™ port x2

Support PD (power & data), once either of USB-C™ port become PD power sink (15V/3A), another port can be PD source (5V/0.9A, 5V/3A, 9V/3A).

USB 2.0 port x2

USB2.0(5V/0.5A)

Technical Specifications

POWER

Power Supply	45W, 87.8% efficient at 15V, active PFC
Operating Voltage Range	90V~265VAC
Rated Voltage Range	100V~240AC
Rated Line Frequency	50~60HZ
Operating Line Frequency Range	47~63HZ
Rated Input Current	<2.2A/120W, 1.4A/45W
Power Cord Length	2 Options: (1) 1m for 120W power adaptor for HP Engage One Prime I/O Hub when it is attached (2) 1m for 45W power adaptor for HP Engage One Prime when HP Engage One Prime I/O Hub is detached.
Current Leakage (45W)	The total combined leakage current when measure in accordance with IEC 60950-1, 2nd Edition shall not exceed 40 microamperes when tested at 250 VAC, 50 Hz in a normal operating condition.

WEIGHTS & DIMENSIONS

HP Engage One Prime	
Product Dimensions	330.2mm(W) x 419.1mm(D) x 127mm(H), 13inch(W) x 16.5inch(D) x 5inch(H)
Weight	5kg/ 10.8lb

HP Engage One Prime unit (Base Unit)	
Product Dimensions	334mm(W) x 260mm(L) x 127mm(H), 13.15inch(W) x 10.24inch(L) x 5inch(H)
Dimension Note	

Scanner	
Product Dimensions	101.6mm(W) x 196.85mm(D) x 101.6mm(H), 4inch(W) x 7.75inch(D) x 4inch(H)
Weight	0.5kg/ 1lb

Printer	
Product Dimensions	158.75mm(W) x 222.25mm(D) x 177.8mm(H), 6.25inch(W) x 8.75inch(D) x 7inch(H)
Weight	0.9kg/ 2lb

Packaging Carton (Base Unit)	
Packaging Dimensions	408mm (L) X 325mm (D) X 220mm (H), 16.02inch(W) x 12.80inch(L) x 8.66inch(H)

Technical Specifications

MISCELLANEOUS FEATURES

Power LED behavior:

1. System is on, the LED is constant on.
2. System is off, the LED is off.
3. System is in sleep, the LED is breathing (fade-in for 3s and fade-out for 3s)

TEMPERATURE, HUMIDITY, ALTITUDE Specifications

Temperature	Operating	32°F to 95° F (0 to 35° C)
	Non-operating	-22° to 149° F (-30°to 65° C)
Relative humidity	Operating	10 to 90%
Altitude (unpressurized)	Operating	0 to 10,000 ft (3,048 m)
	Non-operating	0 to 30,000 ft (9,144 m)

Technical Specifications

ENVIRONMENTAL & INDUSTRY

Environmental Data

Eco-Label Certifications & declarations

This product has received or is in the process of being certified to the following approvals and may be labeled with one or more of these marks:

- US ENERGY STAR®
- EPEAT® Sliver registered in the United States. See <http://www.epeat.net> for registration status in your country. Search keyword generator on HP's 3rd party option store for solar generator accessories at www.hp.com/go/options.

System Configuration

The configuration used for the Energy Consumption for the Engage One Prime model is based on a typically configured system.

Energy Consumption (in accordance with US ENERGY STAR® test method)

	115VAC, 60Hz	230VAC, 50Hz	100VAC, 50Hz
Normal Operation (Short idle)	9.91 W	9.88 W	9.77 W
Normal Operation (Long idle)	3.93 W	3.90 W	3.88 W
Sleep	3.93 W	3.90 W	3.88 W
Off	0.49 W	0.53 W	0.49 W

NOTE: Energy efficiency data listed is for an ENERGY STAR® compliant product if offered within the model family . HP computers marked with the ENERGY STAR® Logo are compliant with the applicable U.S. Environmental Protection Agency (EPA) ENERGY STAR® specifications for computers.

Heat Dissipation*

	115VAC, 60Hz	230VAC, 50Hz	100VAC, 60Hz
Normal Operation (Short idle)	34 BTU/hr	34 BTU/hr	33 BTU/hr
Normal Operation (Long idle)	13 BTU/hr	13 BTU/hr	13 BTU/hr
Sleep	13 BTU/hr	13 BTU/hr	13 BTU/hr
Off	2 BTU/hr	2 BTU/hr	2 BTU/hr

***NOTE:** Heat dissipation is calculated based on the measured watts, assuming the service level is attained for one hour.

Declared Noise Emissions (in accordance with ISO 7779 and ISO 9296)

	Sound Power (LWAd, bels)	Sound Pressure (LpAm, decibels)
Typically Configured – Idle	0	0
Fixed Disk – Random writes	0	0

Technical Specifications

Additional Information

- This product is in compliance with the Restrictions of Hazardous Substances (RoHS) directive - 2011/65/EC.
- This HP product is designed to comply with the Waste Electrical and Electronic Equipment WEEE Directive^{1,2}.
- This product is in compliance with California Proposition 65 (State of California; Safe Drinking Water and Toxic Enforcement Act of 1986).
- This product is in compliance with the IEEE 1680 (EPEAT) standard at the <Sliver> level, see www.epeat.net
- Plastics parts weighing over 25 grams used in the product are marked per ISO11469 and ISO1043.
This product is 96% recycle-able when properly disposed of at end of life.

¹ Directive 2012/19/EU of the European Parliament and of the Council of 4 July 2012 on waste electrical and electronic equipment (WEEE) (recast)

² Directive 2002/96/EC of the European Parliament and of the Council of 27 January 2003 on waste electrical and electronic equipment (WEEE)

Packaging Materials

External:	PAPER/Paper	796 g
Internal:	PLASTIC/Polyethylene Expanded - EPE	172 g
	PLASTIC/Polyethylene low density – LDPE	15 g

The EPE/LDP foam packaging material is made from 0% recycled content.

The paper packaging materials contains at least 90% recycled content.

Material Usage

This product does not contain any of the following substances in excess of regulatory limits (refer to the HP General Specification for the Environment at <http://www.hp.com/hpinfo/globalcitizenship/environment/pdf/gse.pdf>):

- Asbestos
- Certain Azo Colorants
- Certain Brominated Flame Retardants – may not be used as flame retardants in plastics
- Cadmium
- Chlorinated Hydrocarbons
- Chlorinated Paraffins
- Formaldehyde
- Halogenated Diphenyl Methanes
- Lead carbonates and sulfates
- Lead and Lead compounds
- Nickel – finishes must not be used on the external surface designed to be frequently handled or carried by the user.
- Ozone Depleting Substances
- Polybrominated Biphenyls (PBBs)
- Polybrominated Biphenyl Ethers (PBBEs)
- Polybrominated Biphenyl Oxides (PBBOs)
- Polychlorinated Biphenyl (PCB)
- Polychlorinated Terphenyls (PCT)
- Polyvinyl Chloride (PVC) – except for wires and cables, and certain retail packaging has been voluntarily removed from most applications.
- Radioactive Substances
- Tributyl Tin (TBT), Triphenyl Tin (TPT), Tributyl Tin Oxide (TBTO)

Technical Specifications

Packaging Usage

HP follows these guidelines to decrease the environmental impact of product packaging:

- Eliminate the use of heavy metals such as lead, chromium, mercury and cadmium in packaging materials.
- Eliminate the use of ozone-depleting substances (ODS) in packaging materials.
- Design packaging materials for ease of disassembly.
- Maximize the use of post-consumer recycled content materials in packaging materials.
- Use readily recyclable packaging materials such as paper and corrugated materials.
- Reduce size and weight of packages to improve transportation fuel efficiency.
- Plastic packaging materials are marked according to ISO 11469 standards.

End-of-life Management and Recycling

HP Inc. offers end-of-life HP product return and recycling programs in many geographic areas. To recycle your product, please go to: <http://www.hp.com/go/reuse-recycle> or contact your nearest HP sales office. Products returned to HP will be recycled, recovered or disposed of in a responsible manner.

The EU WEEE Directive 2012/19/EU requires manufacturers to provide treatment information for each product type for use by treatment facilities. This information (product disassembly instructions) is posted on the HP Inc. web site at: <http://www.hp.com/go/recyclers>. These instructions may be used by recyclers and other WEEE treatment facilities as well as HP OEM customers who integrate and re-sell HP equipment.

HP Inc. Corporate Environmental Information

For more information about HP's commitment to the environment

Global Citizenship Report

<http://www.hp.com/hpinfo/globalcitizenship/gcreport/index.html>

Eco-label certifications

<http://www8.hp.com/us/en/hp-information/environment/ecolabels.html>

ISO 14001 certificates:

[PC Product Design ISO 14001 certificate](#)

and

[HP Operations ISO 14001 certificate](#)

SERVICE AND SUPPORT

1/1/0 + Advanced Exchange limited warranty delivers on-site, next business day^{1,2} service for parts and labor and complimentary limited technical support.³ Service offers terms up to 3 years by choosing an optional HP Care Service.⁴ To choose the right level of service for your HP product, visit HP Care Pack Central: <http://www.hp.com/go/cpc>

NOTES:

1. Terms and conditions may vary by country. Certain restrictions and exclusions apply. Other warranty variations may be offered in your region.
2. On-site service may be provided pursuant to a service contract between HP and an authorized HP third-party provider, and is not available in certain countries. Global service response times are based on commercially reasonable best effort and may vary by country.
3. Technical support applies only to HP-configured Compaq and third-party HP-qualified hardware and software. 24 x 7 support may not be available in some countries.
4. HP Care Services are optional. Service levels and response times for HP Care Services may vary depending on your geographic location. Service starts on date of hardware purchase. Restrictions and limitations apply. For details, visit <http://www.hp.com/go/cpc>. HP services are governed by the applicable HP terms and conditions of service provided or indicated to Customer at the time of purchase. Customer may have additional statutory rights according to applicable

Technical Specifications

local laws, and such rights are not in any way affected by the HP terms and conditions of service or the HP Limited Warranty provided with your HP Product

HP Engage One Prime Peripherals

HP Engage One Prime Receipt Printer



Model

HP Engage One Prime Receipt Printer	4VW55AA/AT
HP Engage One Prime White Receipt Printer	4VW61AA/AT

Print Method	Direct Thermal
Printing Speed	90 mm/sec (max.)
Resolution	8 dots/mm (203 DPI)
Flash Memory	8 MB
RAM	8 MB
Knife	Full and Partial cuts supported
Paper Type	Thermal continuous paper, Thermal marked paper
Paper Roll Width	58mm (2.25")
Paper Roll Diameter	51mm (max) (2.01")
Paper Thickness Range	0.06mm~0.10mm thermal paper
Sensor	Thermal Printhead Detection Cover Detection Paper Engaged
Cash Drawers	Two cash drawers (RJ12)
Dimensions	96mm (diameter) x 119.5mm (height)
Weight	620g
Color	Black/White
Interface	USB Type-C™
Power Input	9V 4A
Operating Temperature	-10°C to 40°C
Operating Humidity	20% to 90%

HP Engage One Prime Peripherals

Reliability

MTBF 300,000 hrs
Printhead life 50km

Software

Cutter life 500,000 times
JPOS supporting Android 8.1

HP Engage One Prime Peripherals

HP Engage One Prime Barcode Scanner



Models

HP Engage One Prime Barcode Scanner

4VW58AA/AT

HP Engage One Prime White Barcode Scanner

4VW64AA/AT

Scanner Type	2D Linear Imager	
Light source	White LED	
Resolution	≥4 mil	
Depth of Field	Typical Performance *	
	Narrow Width	Depth of Field
	EAN-13	60mm-215mm (2.4in-8.5in) (13 mil)
	QR Code	40mm-105mm (1.6in-4.1in) (15 mil)
Symbol Contrast	25% minimum reflectance	
Roll (tilt)	360°	
Pitch	± 45°	
Skew	± 40°	
1D decode symbologies	EAN-8 EAN-13 UPC-E UPC-A Code 128 UCC/EAN 128 I2Of5 ITF14 ITF6 Matrix 25 CodaBar Code 39 Code 93 ISSN ISBN	

HP Engage One Prime Peripherals

2D decode symbologies

- Industrial 25
- Standard 25
- Plessey Code 11
- MSI Plessey UCC/EAN
- Composite GS1
- Databar
- China Post 25
- Code 49
- Code 16K

Postal decode symbologies

- PDF417
- QR Code Micro
- QR Data
- Matrix Aztec
- Maxicode
- Chinese Sensible Code
- GM Code MicroPDF417
- Code One

Postal decode symbologies

- USPS Postnet
- Royal Mail KIX Post
- Australian Postal

Mechanical

Dimensions (L x W x H)	145 x 101 x 68 mm (5.7 x 3.97 x 2.7 in)
Weight	115 g (4.1 oz)
Cable length	1.8 m (6.5 ft)
Color	Black

Interface/Connection

Interface	USB
------------------	-----

Temperature

Operating	-4 to 140 °F (-20 to 60 °C)
Storage/transport	-40 to 158 °F (-40 to 70 °C)
Humidity (non-condensing)	5 ~ 95%

Power

Standby Current	58.6mA
Operating	165.8mA (typical), 170.2mA (max)

Drivers

Windows UBB HID-KB and OPOS & JPOS (via USB-COM mode drivers)

Reliability

Water Penetration Protection IP42

Drop ESD	1.2 m (3.2 ft)
	±8kV (direct discharge)
	±15kV (air discharge)

HP Engage One Prime Peripherals

Operating System

Compatible with:

Windows 10 (32-bit)
Windows 10 (64-bit)
Windows 10 IoT (32-bit)
Windows 10 IoT (64-bit)
Windows 8.1 Professional (32-bit)
Windows 8.1 Professional (64-bit)
Windows Embedded 8.1
Windows 7 Business (64-bit)
Windows Embedded POS Ready 7 (64-bit)
Windows Embedded POS Ready 2009

Agency Certifications

FCC Part15, Class B, CE EMC Class B, IEC62471, RoHS

Option Kit Contents

HP Engage One Prime Barcode Scanner, Scanner Stand, USB Cable.

HP Engage One Prime Peripherals

HP Engage One Prime Fingerprint Reader



Models

HP Engage One Prime FPR

4VW57AA/AT

HP Engage One Prime White FPR

4VW63AA/AT

General	Scan Data	8-bit grayscale (256 levels of gray)
	Pixel resolution	508 DPI
	Scan capture area	18mm x 1280mm
Mechanical	Standalone Dimensions(LxWxH)	162 x 30 x 20.7 (mm) (6.38 x 1.18 x .81 in)
	Attached Dimensions (LxWxH)	162x30 x29.2 (mm) (6.38 x 1.18 x 1.15 in)
	Standalone Weight	79g (2.79 oz)
	Attached Weight	116g (4.09 oz)
	Color	Ebony Black or Ceramic White
Interface/Connection	Interface	USB 2.0
Power	Supply Voltage	5.0V ±5% supplied by USB
	Supply Current Imaging Mode	80 mA @ 3.3V
	Supply Current Sleep Mode	1350 uA @ 3.3V
Environmental	Temperature	- 20 C to + 70 C
	Humidity	5% to 93% RH w/o condensation
Drivers		Windows
Operating Systems	Compatibility	Windows Windows 10 IoT Enterprise for Retail 64-bit*, ***

HP Engage One Prime Peripherals

Windows 10 Professional 64-bit*,***
Windows 8.1 Professional 64-bit**
Windows Industry 8.1 Pro Retail 64-bit**
Windows 7 Professional 64-bit**
Windows 7 Professional 32-bit**
Windows Embedded POSReady 7 64-bit**
Windows Embedded POSReady 7 32-bit**

Linux

Ubuntu 12.04
Ubuntu 13.04
Ubuntu 14.04

Reliability

Surface Coating

Scratch Resistant
Withstands more than 4 million rubs

Readability

More than 100,000 read/write cycle
More than 20 yrs data retention
Works well with dry, moist, or rough fingerprints

Security

Counterfeit Finger Rejection
Latent Print Rejection
Encryption Fingerprint Data

HP Engage One Prime Peripherals

HP Engage One Prime iButton Reader



Models

HP Engage One Prime iButton Reader

4VW56AA/AT

HP Engage One Prime White iButton Reader

4VW62AA/AT

Standalone Dimensions (LxWxH)	162x30x20.7mm (6.38x1.18x0.81in)
Standalone Weight	80g (2.82 oz)
Color	Ebony Black or Ceramic White
Interface	USB 2.0
Supply Voltage	5.0V+/- 5% supplied by USB
Supply Current	80mA@3.3V
Operating Temperature	-20C to 50C
Operating Humidity	5% to 93% RH w/o condensation
Operating Systems	Windows and Android compatible
iButton support format	DS1990A serial number iButton
Status LED Indiacator	Yes (Activated, Error, Connected)
Agency	WW

HP Engage One Peripherals

HP Engage One Prime I/O Hub



Models

HP Engage One Prime I/O Hub	4VW60AA/AT
HP Engage One Prime White I/O Hub	4VW66AA/AT

General	Ports	<ul style="list-style-type: none"> 1 USB-C™ PD port dedicated for host platform (PD power source up to 15V/3A) 1 USB-C™ PD port dedicated for peripheral (PD power source: 9V/3A, 5V/3A, 5V/0.9A) 4 USB-A ports (USB 2.0) 1 Powered USB port (12V) combined with 1 USB-A port (USB2.0) 2 Powered RS232 ports (0/5/12V can be set in HP Engage One Prime OS setting menu) 1 RJ12 port (24V/1A) for cash drawer 1 RJ45 Ethernet port (10/100/1000)
LED Behavior	When host is connected When host is removed Power on without host When error occurs	<ul style="list-style-type: none"> On/off with host is on/off; breathing with host is breathing On for 15 seconds then breathing On for 15 seconds then breathing Blinking
Weight Dimension		<ul style="list-style-type: none"> 1.08lb (490g) 55mm(W) x 220mm(L) x 26.4mm(H) (2.17inch x 8.66inch x 1.04inch)
Power adaptor requirement Temperature	Rated power	120W, 19.50V +/-5%, 6.15A(HP 4.5mm Barrel type)
Relative humidity Altitude	Operating Non-operating Operating Operating Non-operating	<ul style="list-style-type: none"> 32~95 °F (0~35 °C) -22~149 °F (-30~+65 °C) 10%~90% RH, 10000 ft. (3048 m) 30000 ft. (9144 m)

HP Engage One Peripherals

Network manageability
Power Delivery (PD)

Wake On Lan (WoL) is not supported with HP Engage One Prime or HP Engage One Prime Plus
Support HP proprietary dynamic PD configuration when connecting with HP Engage One Prime
or HP Engage One Prime Plus

Option Kit Contents

HP Engage One Prime I/O Hub, Documentation

HP Engage One Peripherals

HP Engage One Prime Cash Drawer



Models

HP Engage One Prime Cash Drawer	4VW59AA/AT
HP Engage One Prime White Cash Drawer	4VW65AA/AT

Construction	Robust Steel
Key Lock	Keyed alike (#435)
Media Storage	1 media posting slot
Till Insert	5 bill/8 coin or 4 bill/8 coin
Lock Options	Electronic open, manual open, deadlocked
Dimensions (L x W x H)	336 x 336 x 101mm 13.22 x 13.22 x 3.97 inches
Weight	5.0 kg (11 lb)
Color	Black/White
Connection Interface	RJ12/24V
Cable Length	1803 mm +/- 25.4mm (71" +/- 1")
Operating	40°F to 105°F (5°C to 40°C)
Storage/Transport	-40°F to 158°F (-40°C to 70°C)
Humidity (non-condensing)	10% to 95% relative humidity

HP Engage One Peripherals

Operating voltage	24VDC
Agency	CE, WEEE

Cable Routing Configurations

HP Engage One cable matrix

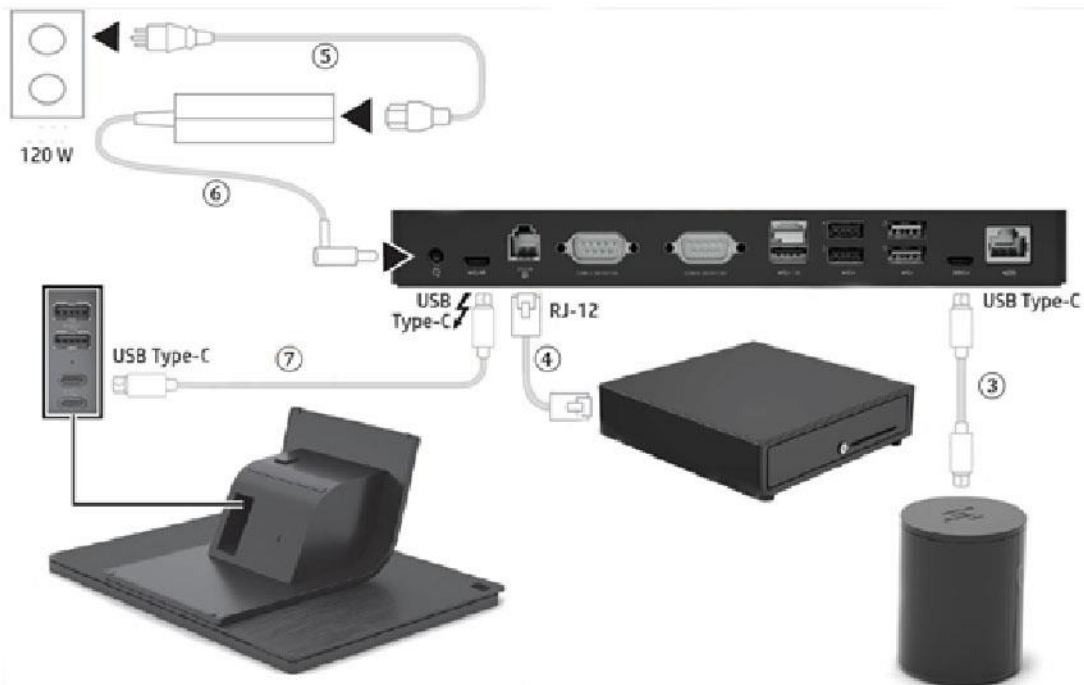
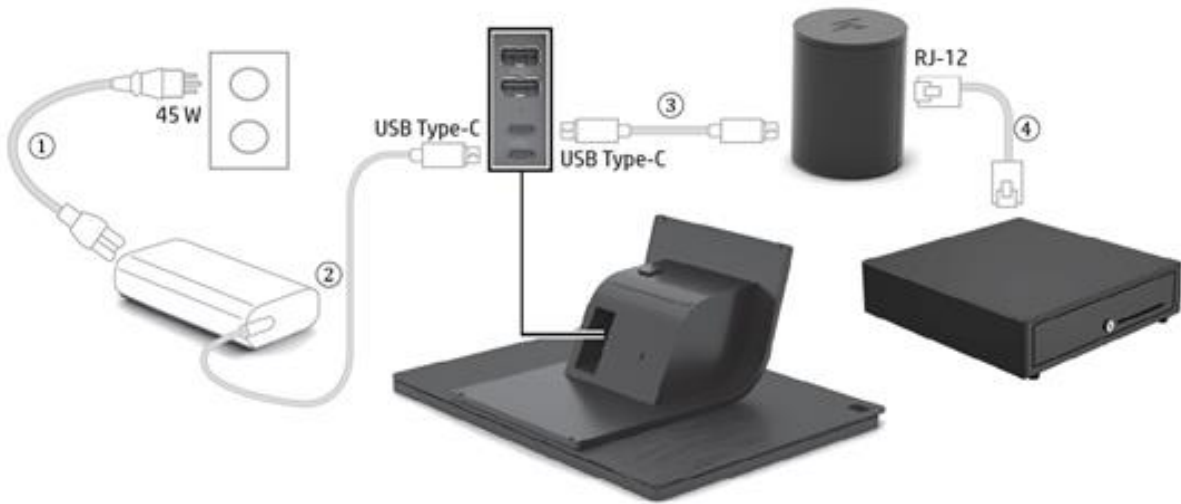

Cables

1. 45W USB-C™ power adapter cord
2. 45W USB-C™ power adaptor USB-C™ cable (captive with the power adaptor)
3. USB-C™ to USB-C™ thermal printer cable
4. RJ-12
5. 120W barrel type power adaptor cord.
6. 120W barrel type power adaptor power cable (4.5 mm barrel)
7. USB-C™ to USB-C™ cable for connecting HP Engage One prime to HP Engage One Prime I/O Hub

Cable Routing Configurations

4. RJ12 cash drawer cable (for some HP cash drawer, it might be captive with the cash drawer)

HP Engage One Prime Peripherals Summary

AM0 Kit	Black
4VW55AA/AT	HP Engage One Prime Receipt Printer
4VW56AA/AT	HP Engage One Prime iButton Reader
4VW57AA/AT	HP Engage One Prime FPR
AV only	HP Engage One Prime MSR
4VW58AA/AT	HP Engage One Essential Barcode Scanner
4VW59AA/AT	HP Engage One Prime Cash Drawer
4VW60AA/AT	HP Engage One Prime I/O Hub
	White
4VW61AA/AT	HP Engage One Prime White Receipt Printer
4VW62AA/AT	HP Engage One Prime White iButton Reader
4VW63AA/AT	HP Engage One Prime White FPR
AV Only	HP Engage One Prime White MSR
4VW64AA/AT	HP Engage One Prime White Barcode Scanner
4VW65AA/AT	HP Engage One Prime White Cash Drawer
4VW66AA/AT	HP Engage One Prime White I/O Hub

Summary of Changes

Date of change:	Version History:		Description of change:
April 9, 2019	From v1 to v2	Changed	ENVIRONMENTAL & INDUSTRY section
September 13, 2019	From v2 to v3	Changed	WEIGHTS & DIMENSIONS section
February 10, 2020	From v3 to v4	Changed	Note 2 added in MSR section MSR swapped into Magnetic Stripe Reader Typo corrected in MSR section
March 24, 2020	From v4 to v5	Changed	Format page 6

Copyright © 2020 HP Development Company, L.P. The information contained herein is subject to change without notice. The only warranties for HP products are set forth in the express limited warranty statements accompanying such products. Nothing herein should be construed as constituting an additional warranty. HP shall not be liable for technical or editorial errors or omissions contained herein.

Microsoft and Windows are registered trademarks or trademarks of Microsoft Corporation in the U.S. and/or other countries. Linux is the registered trademark of Linus Torvalds in the U.S. and other countries. Bluetooth® is a registered trademark of its proprietor and used by HP Inc. under license. ENERGY STAR® is a registered trademark owned by the U.S. Environmental Protection Agency. Google and Android are trademarks of Google LLC. USB Type-C™ and USB-C™ are trademarks of USB Implementers Forum.